

Excellent Integrated System Limited

Stocking Distributor

Click to view price, real time Inventory, Delivery & Lifecycle Information:

[Molex Connector Corporation](#)
[1041340221](#)

For any questions, you can email us directly:

sales@integrated-circuit.com

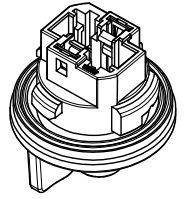
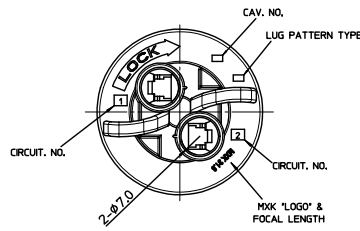
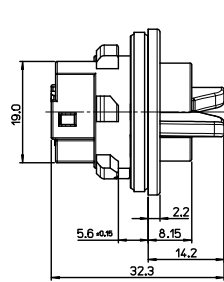
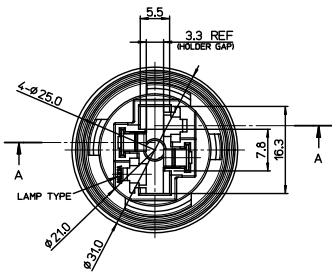

ISO VIEW

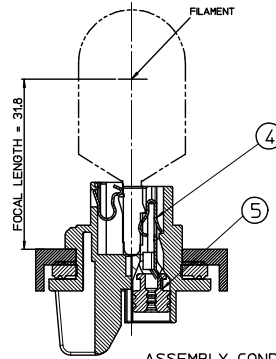

ASSEMBLY CONDITION

SECTION A-A

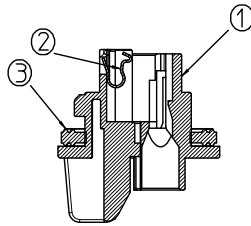

<NOTE>

1. APPLICABLE LAMP : W21W(T20)
2. PANEL THICKNESS : 3.0mm ±0.1
3. MATES WITH

NO.	DESCRIPTION	MATERIAL	PART NO.	WIRE RANGE
④	SINGLE TERMINAL	BRASS	49869-9702	0.5~0.85mm ²
⑤	WIRE SEAL - S	SILICONE	49454-9002	1.8~2.2mm(INS. DIA.)

<PARTS LIST>

NO.	DESCRIPTION	MATERIAL	USAGE	REMARK
①	T20 BULB SOCKET	NYLON46, GF 30%	1	BLACK
②	LAMP HOLDER	SUS	2	UNPLATED
③	FLOOR SEAL	SILICONE	1	WHITE

<TABLE 1>

MATERIAL NO.	ORDER NO.	COLOR
1041340221	104134-0221	BLACK

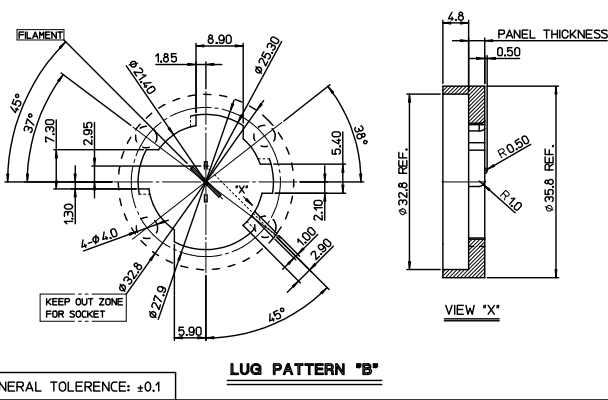

LUG PATTERN "B"

GENERAL TOLERANCE: ±0.1

NEW RELEASE EC NO: KTR2013-0011 DRAWN BY: DRW/HH/00N CHKD BY: CH/KCB/00N APPR: JYCHOI DATE: 2013/08/28 2013/09/04	QUALITY SYMBOLS ▽=0 ▽=0	GENERAL TOLERANCES (UNLESS SPECIFIED)		DIMENSION STYLE		SCALE	DESIGN UNITS	THIRD ANGLE PROJECTION
		mm	INCH	MM ONLY	DATE			
DESCRIPTION REV: A	DRAWN BY: SMK/IM CHECKED BY: BGYOON APPROVED BY: JYCHOI DATE: 2009/03/17 2009/03/17 2013/09/04	4 PLACES	±---	±---		TITLE W21W(T20) SEALED WEDGE BULB SOCKET 2P	MOLEX INCORPORATED	SHEET NO. 1 OF 00
		3 PLACES	± 0	±---				
		2 PLACES	± 0.2	±---				
		1 PLACE	± 0.30	±---				
		ANGULAR ± 1°						
DRAFT WHERE APPLICABLE MUST REMAIN WITHIN DIMENSIONS		SEE TABLE 1		DOCUMENT NO. SD-104134-002				
THIS DRAWING CONTAINS INFORMATION THAT IS PROPRIETARY TO MOLEX INCORPORATED AND SHOULD NOT BE USED WITHOUT WRITTEN PERMISSION								