

## Excellent Integrated System Limited

Stocking Distributor

Click to view price, real time Inventory, Delivery & Lifecycle Information:

[Molex Connector Corporation](#)  
[0397040006](#)

For any questions, you can email us directly:

[sales@integrated-circuit.com](mailto:sales@integrated-circuit.com)

PART NUMBER DATA							
CIRCUITS	PART NUMBER	ENGINEERING NUMBER	COLOR	A IN mm	B IN mm		
2	397040002	M750B-03-5-02-3	GREEN	.52	13.2	.300	7.62
3	397040003	M750B-03-5-03-3	GREEN	.82	20.8	.600	15.23
4	397040004	M750B-03-5-04-3	GREEN	1.12	28.5	.900	22.85
5	397040005	M750B-03-5-05-3	GREEN	1.42	36.1	1.200	30.47
6	397040006	M750B-03-5-06-3	GREEN	1.72	43.7	1.500	38.09
7	397040007	M750B-03-5-07-3	GREEN	2.02	51.3	1.799	45.70
8	397040008	M750B-03-5-08-3	GREEN	2.32	58.9	2.099	53.32
9	397040009	M750B-03-5-09-3	GREEN	2.62	66.6	2.399	60.94
10	397040010	M750B-03-5-10-3	GREEN	2.92	74.2	2.699	68.56
11	397040011	M750B-03-5-11-3	GREEN	3.22	81.8	2.999	76.17
12	397040012	M750B-03-5-12-3	GREEN	3.52	89.4	3.299	83.79

REF. LAST 2 DIGITS OF PART NUMBER EQUALS NUMBER OF POLES

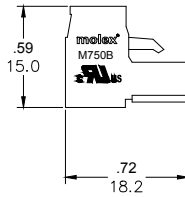
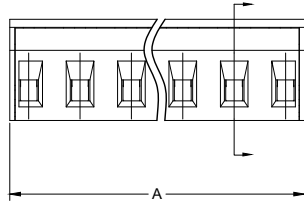
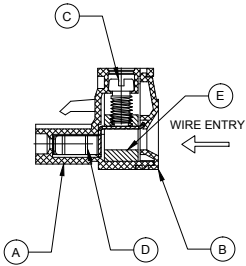
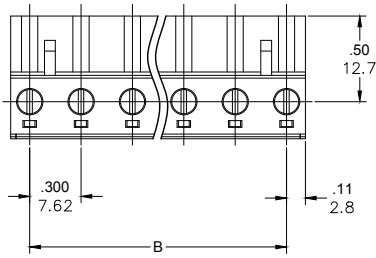

ENGINEERING NUMBER LEGEND

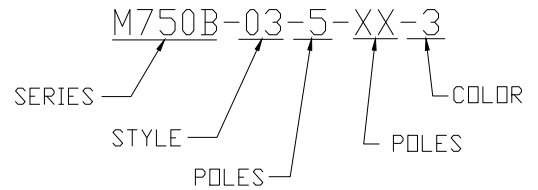

CONTACT FACTORY FOR OPTIONAL COLORS

SPECIFICATIONS

1. MATERIAL:

- A. BODY: PA66.UL94 V-0
- B. COVER: PA66.UL94 V-0
- C. TERMINAL SCREW: M3, STEEL. ZINC PLATED
- D. CONTACT: COPPER ALLOY. TIN PLATED
- E. CAGE: BRASS NICKEL PLATED

2. WIRE SIZE: 30 - 12AWG.

3. RATING: 15A AT 51-150V, 10A AT 151 TO 300V

4. SCREW TORQUE: 5.0 IN. LBS.

5. WIRE STRIP LENGTH: .20 (5.0mm).

6. OPERATING TEMPERATURE: -40°C TO +105°C

7. MATES WITH HEADER SERIES: 39723

8. DIMS SHOWN ARE FOR REFERENCE ONLY

RELEASED EC NO: JPC2014-1194 DRWN: RSTONE 2014/01/22 CHKD: G. FARNS APPR: JFMURPHY 2014/10/16 A	QUALITY SYMBOL ▽=0 ▽=0	GENERAL TOLERANCES (UNLESS SPECIFIED)		DIMENSION STYLE IN/MM		SCALE ---	DESIGN UNITS METRIC	THIRD ANGLE PROJECTION
		4 PLACES ±-- ±-- 3 PLACES ±-- ±.005 2 PLACES ±0.13 ±.01 1 PLACE ±0.3 ±-- ANGULAR ±--°	DRAWN BY RSTONE CHECKED BY G. FARNS APPROVED BY JFMURPHY MATERIAL NO. SEE CHART SIZE C	DATE 2014/01/22 DATE --- DATE 2014/10/16	TITLE 7.62 EURO PLUG RIGHT ANGLE NO MTG ENDS MOLEX INCORPORATED DOCUMENT NO. SD-39704-001 SHEET NO. 1 OF 1			

DRAFT WHERE APPLICABLE MUST REMAIN WITHIN DIMENSIONS

THIS DRAWING CONTAINS INFORMATION THAT IS PROPRIETARY TO MOLEX INCORPORATED AND SHOULD NOT BE USED WITHOUT WRITTEN PERMISSION