

Excellent Integrated System Limited

Stocking Distributor

Click to view price, real time Inventory, Delivery & Lifecycle Information:

[LEMO](#)

[PEN.3F.322.XLM](#)

For any questions, you can email us directly:

sales@integrated-circuit.com

PEN.3F.322.XLM

SUMMARY

Wires

Low	22
High	0
Coax	0
Triax	0
Quad	0
Fiber	0
Fluidic	0



Download

[Request a quote](#)

[Catalog](#)

Series	3F
Termination type	Female crimp
IP rating	67
Cable Ø	5.30 - 16.00 mm
Matching parts	xxx

TECHNICAL DETAILS

Mechanics

Shell Style/Model	PE*: Straight receptacle, nut fixing (back panel mounting)
Keying	3 keys (beta=150, gamma=60, plug: male contacts, receptacle: female contacts)
Housing Material	Environment friendly aluminium (nickel plated, anthracite color) shell and nut, other pieces bronze/brass
Cable Fixing	∅ 5.3 - 16 mm
Variant	

Performance

Configuration	3F.322 : 22 Low Voltage
Insulator	L: PEEK (UL 94 / V-0/3.2, depends on material thickness)
Rated Current	5.5 Amps

Specifications

Contact Type:	Crimp
Max. Matings:	5000
Contact Retention:	22 N
Contact Dia.:	0.7 mm (0.028in)
Bucket Dia.:	0.8 mm (0.031in)
Min. Conductor:	0.14 mm ² (AWG 26)
Max. Conductor:	0.34 mm ² (AWG 22)

R (max): 6.1 mOhm
 Vtest (contact-shell): 1450 V (AC), 2050 V (DC)
 Vtest (contact-contact): 1700 V (AC), 2400 V (DC)

Others

Endurance (Shell): 1000 mating cycles
 Temp (min / max): -15°C / +200°C
 Humidity (max): <=95% [at 60 deg C / 140 F]
 Vibration: 15 g [10 Hz - 2000 Hz]
 Shock Resistance: 100 g [6 ms]
 Climatological Category: 15/200/21 (Aluminium shell)
 IP Rating: 67

DRAWINGS

Draws

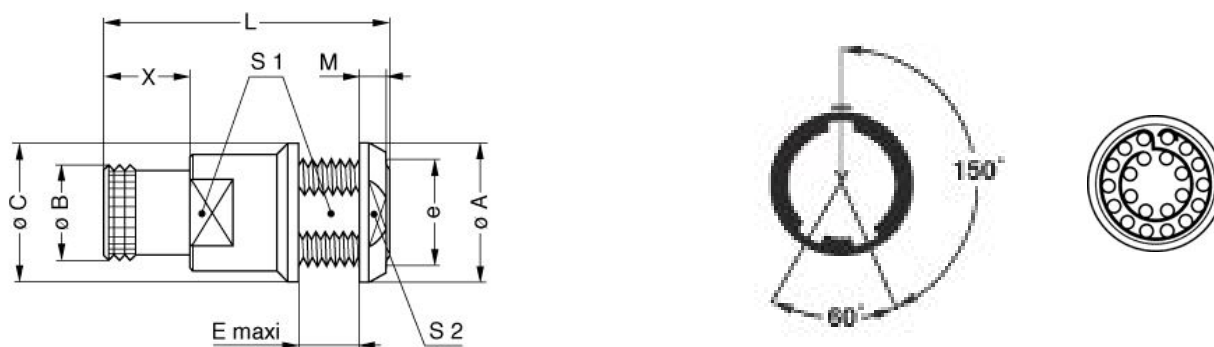

Dimensions

	A	L
mm.	14	45
in.	0,55	1,77

RECOMMENDED BY LEMO

Tools

Crimp Tool: DPC.91.701.V
 Positionner: DCE.91.070.BVM
 Extractor: DCF.93.070.4LT
 Replacement contact: EGG.3F.655.ZZM

Cables

CMN.22.T22.088PGCE	PVC	GREY	
CMN.22.T22.088PGZE		Grey	
CMN.22.T22.088PNCE	PVC	Black	
CMN.22.T22.088PNZE			
CMN.22.T30.054QGZE	TPR (medical)	Grey	