



Distributor of Molex Connector Corporation: Excellent Integrated System Limited
Datasheet of 67298-4000 - Connector Receptacle USB TypeA, Stacked 8 Position Through
Hole, Right Angle, Horizontal

Contact us: sales@integrated-circuit.com Website: www.integrated-circuit.com

Excellent Integrated System Limited

Stocking Distributor

Click to view price, real time Inventory, Delivery & Lifecycle Information:

[Molex Connector Corporation](#)
[67298-4000](#)

For any questions, you can email us directly:
sales@integrated-circuit.com

Contact us: sales@integrated-circuit.com Website: www.integrated-circuit.com

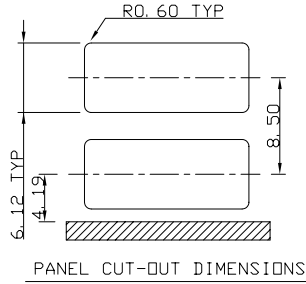
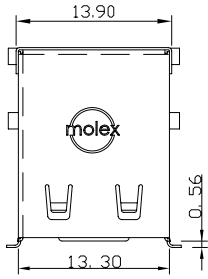

PANEL CUT-OUT DIMENSIONS

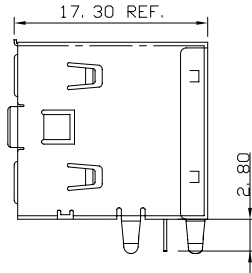
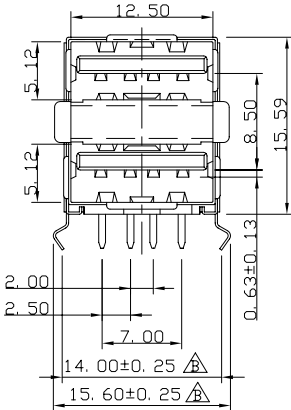

P/N	COLOR	CONTACT PLATING
67298-3000	BLACK	GOLD FLASH
67298-4000	WHITE	GOLD FLASH
67298-3001	BLACK	30u" GOLD
67298-4001	WHITE	30u" GOLD

- NOTE :
- MATERIAL :
 HOUSING : POLYESTER(PBT), 30% GLASS FIBER FILLED, UL94-V0, COLOR: WHITE OR BLACK
 TERMINAL : PHOSPHOR BRONZE
 METAL SHELL : SPCC & SUS
 - PLATING :
 TERMINAL :
 CONTACT AREA : SEE TABLE
 SOLDER TAIL : TIN-LEAD (Sn-Pb) ALLOY, THICKNESS=75 MICROINCH MIN.
 /1.9 MICROMETER MIN.
 UNDER PLATE : NICKEL (Ni), THICKNESS=50 MICROINCH MIN.
 /1.27 MICROMETER MIN.
 METAL SHELL : TIN PLATING, THICKNESS=50 MICROINCH MIN.
 /2.54 MICROMETER MIN.
 UNDER PLATE : NICKEL (Ni), THICKNESS=50 MICROINCH MIN.
 /1.27 MICROMETER MIN.
 - RECOMMENDED PCB THICKNESS : 1.60+/-0.05mm
 - PRODUCT SPECIFICATION : REFER TO PS-67998-0000
 - PACKAGING REFER TO PK-67298-001
 - THE HOUSING MATERIAL IS NOT FOR IR REFLOW PROCESS OR SURFACE MOUNTING COMPATIBLE PROCESS.

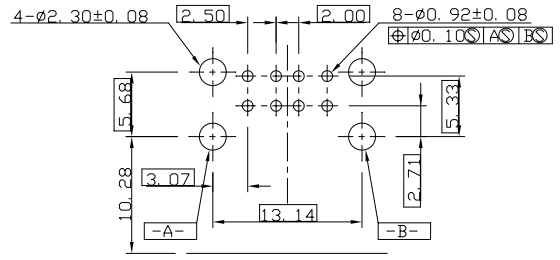

RECOMMENDED PCB LAYOUT

DO NOT SCALE DRAWING

ADD PARTS	EC NO.	DRWN.	CHK'D	APPR.	DESCRIPTION	QUALITY SYMBOLS	GENERAL TOLERANCES (UNLESS SPECIFIED)		SCALE	DESIGN UNITS	THIRD ANGLE PROJECTION	DIMENSIONS:				SHT	REV	
							MM	INCH				MM	INCH	MM	INCH			MM
D	C	B				MAJOR CRITICAL	4 PLACES	3 PLACES	2 PLACES	1 PLACE	ANGULAR: ±3°	DRAFT WHERE APPLICABLE MUST REMAIN WITHIN DIMENSIONS	TITLE: USB DUAL STACKED A CONNECTOR MOLEX INCORPORATED CAD FILENAME: S6729803S1.PDF MATERIAL NO. SEE TABLE DRAWING NO. SD-67298-003 SHEET NO. 1 OF 1					