

Excellent Integrated System Limited

Stocking Distributor

Click to view price, real time Inventory, Delivery & Lifecycle Information:

[E-Switch](#)
[KAT1108E](#)

For any questions, you can email us directly:

sales@integrated-circuit.com

POS. 1 DESIGNATE
PIN #1 LOCATION

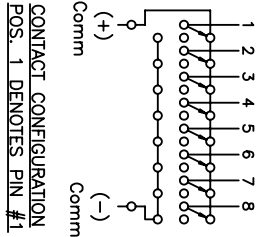
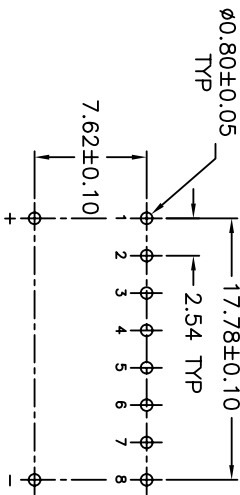
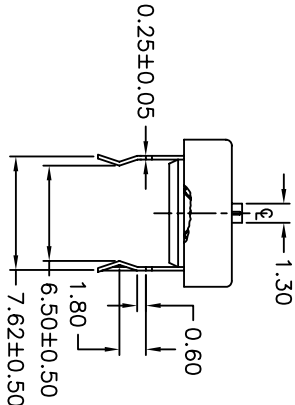
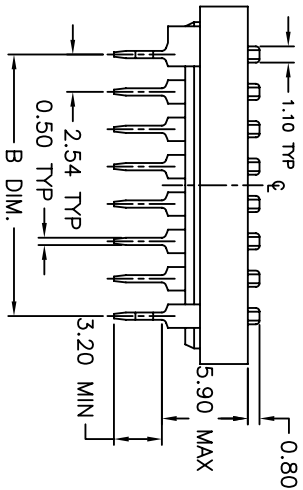
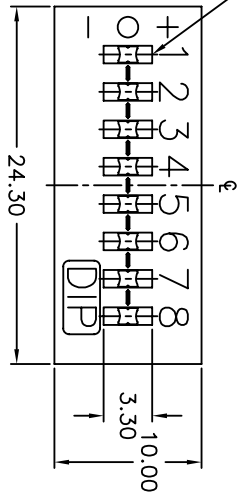

CONTACT CONFIGURATION
POS. 1 DENOTES PIN #1

NOTES:

1. ALL DIMENSIONS IN MM
2. GENERAL TOLERANCE: 0.0±±0.4
0.00±±0.25
3. TERM. NOS. FOR REF. ONLY
4. SWITCHES SUPPLIED IN DESPENSING TUBES PACKAGE WITH ALL POLES IN THE "OFF" POSITION - 19 SWITCHES/TUBE
5. CONTACT RATING: 25mA @24V DC
6. OPERATING LIFE: 2,000 make-and-break cycles
7. OPERATING FORCE: 1000gf max.
8. TRAVEL: 2.0mm typical
9. DIELECTRIC STRENGTH: 500V RMS min @seal level between adj. term.
10. TEMP. RANGE: -40C to 85C

REV.	ECN No.	DESCRIPTION	DATE	CHKD
B	13577	REMOVE TABLE	11/5/03	AR
A	10710	RELEASED FOR PRODUCTION	6/27/00	MM

TITLE	SCALE	DATE	DR	DWG	REV
KAT1108E (8 Pos. DIP Switch)	3:1	6/27/00	MM	N711080	B



Package in Tubes

THE INFORMATION CONTAINED IN THIS DOCUMENT IS PROPRIETARY TO E-SWITCH AND IS NOT TO BE COPIED OR TRANSFERRED