

## Excellent Integrated System Limited

Stocking Distributor

Click to view price, real time Inventory, Delivery & Lifecycle Information:

[Molex Connector Corporation](#)  
[87760-4816](#)

For any questions, you can email us directly:

[sales@integrated-circuit.com](mailto:sales@integrated-circuit.com)

10 9 8 7 6 5 4 3 2 1

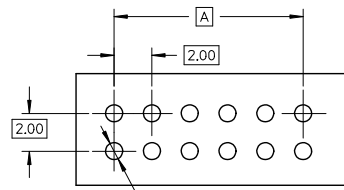

RECOMMENDED PCB LAYOUT

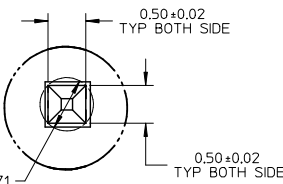
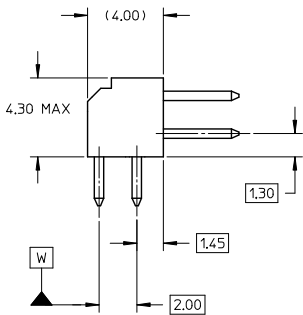

DETAIL Z

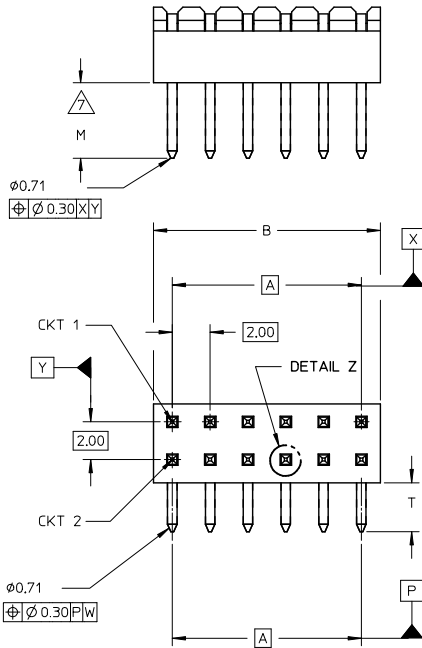

**NOTES:**

**1. MATERIAL:**

HSG: PCT, 30% GLASS FILLED,UL 94V-0,  
COLOUR BLACK.

PIN: 0.50MM SQ PHOSPHOR BRONZE 510

**PLATING:**

\*\*\*5 - 0.05um MIN - 0.25um MAX GOLD IN CONTACT AREA,  
2.00um MIN TIN IN SOLDERTAIL AREA, BOTH OVER  
1.25um MIN NICKEL OVERALL

\*\*\*6 - 0.38um MIN GOLD IN CONTACT AREA,  
2.00um MIN TIN IN SOLDERTAIL AREA, BOTH OVER  
1.25um MIN NICKEL OVERALL

\*\*\*7 - 0.76um MIN GOLD IN CONTACT AREA,  
2.00um MIN TIN IN SOLDERTAIL AREA, BOTH OVER  
1.25um MIN NICKEL OVERALL

\*\*\*8 - 2.54um MIN TIN OVER  
1.25um MIN NICKEL OVERALL

3. 12 CKT USED FOR ILLUSTRATION ONLY

4. PART TO BE PACKED IN POCKET TRAY/TUBE (SEE TABLE).

5. PRODUCT SPEC PS-87761-100 APPLIES.

6. RECOMMENDED PCB BOARD THK 1.60±0.10 MM.

**MATING LENGTH:** 1 - 4.00MM  
2 - 3.50MM  
3 - 3.06MM  
4 - 5.75MM

**PART NUMBERS THAT ARE UNAVAILABLE IN THIS SD:**  
87760-0646, 87760-1046, 87760-1446, 87760-2446, 87760-4046.  
(REFER TO SD-87760-133 FOR THESE PART NUMBERS)

**LEGEND:**

87760 - \* \* \* \*

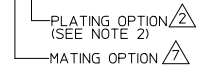

SHT 3, +87760-5516 EC NO: S2013-0842 DRAWN BY: DRWNAISEE CHKD: SKANG APPR: MLONG	2013/05/31 2013/06/28 2013/07/08	DESCRIPTION	QUALITY SYMBOLS	GENERAL TOLERANCES (UNLESS SPECIFIED)		DIMENSION STYLE		SCALE	DESIGN UNITS	THIRD ANGLE PROJECTION
				mm	INCH	MM ONLY	NTS	METRIC		
REV A16	REV	DESCRIPTION	QUALITY SYMBOLS	4 PLACES ±---	±---	DRAWN BY	DATE	TITLE MGRID, 2MM DUAL ROW HDR, R/A <b>molex</b> DOCUMENT NO. SD-87760-109 SHEET NO. 1 OF 3		
				3 PLACES ±---	±---	KSEE	2003/10/15			
				2 PLACES ±0.2	±---	CHECKED BY	DATE			
				1 PLACE ±---	±---	KCLING	2003/12/02			
			0 PLACE ±	±	APPROVED BY	DATE	MATERIAL NO. SEE TABLE THIS DRAWING CONTAINS INFORMATION THAT IS PROPRIETARY TO MOLEX INCORPORATED AND SHOULD NOT BE USED WITHOUT WRITTEN PERMISSION			
			ANGULAR ± 3°	±	SKTOH	2003/12/11				

9 8 7 6 5 4 3 2 1

10	9	8	7	6	5	4	3	2	1
PART NUMBER	VOID PIN LOCATION	CKT SIZE	A	B	M	T	PACKAGING TYPE		
87760-04**	-	04	2.00	4.00	REFER TO NOTE 7	2.60	TRAY		
87760-06**	-	06	4.00	6.00					
87760-08**	-	08	6.00	8.00					
87760-10**	-	10	8.00	10.00					
87760-12**	-	12	10.00	12.00					
87760-14**	-	14	12.00	14.00					
87760-16**	-	16	14.00	16.00					
87760-18**	-	18	16.00	18.00					
87760-20**	-	20	18.00	20.00					
87760-22**	-	22	20.00	22.00					
87760-24**	-	24	22.00	24.00					
87760-26**	-	26	24.00	26.00					
87760-28**	-	28	26.00	28.00					
87760-30**	-	30	28.00	30.00					
87760-32**	-	32	30.00	32.00					
87760-34**	-	34	32.00	34.00					
87760-36**	-	36	34.00	36.00					
87760-38**	-	38	36.00	38.00					
87760-40**	-	40	38.00	40.00					
87760-42**	-	42	40.00	42.00					
87760-44**	-	44	42.00	44.00					
87760-46**	-	46	44.00	46.00					
87760-48**	-	48	46.00	48.00					
87760-50**	-	50	48.00	50.00					

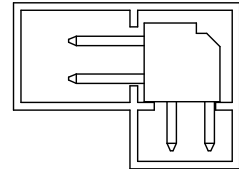

PART IN TUBE

SHT 3, +87760-5516 IEC NO. S2013-0842 DRAWN BY: DRWATSEE CHKD: SKANG APPROV: LONG	QUALITY SYMBOLS	GENERAL TOLERANCES (UNLESS SPECIFIED) mm    INCH 4 PLACES ± --- ± --- 3 PLACES ± --- ± --- 2 PLACES ± 0.2 ± --- 1 PLACE ± --- ± --- 0 PLACE ±    ± --- ANGULAR ± 3° DRAFT WHERE APPLICABLE MUST REMAIN WITHIN DIMENSIONS	DIMENSION STYLE MM ONLY		SCALE NTS	DESIGN UNITS METRIC	THIRD ANGLE PROJECTION	
	DESCRIPTION		DRAWN BY	DATE	TITLE			
	REV		CHECKED BY	DATE	MGRID, 2MM DUAL ROW HDR, R/A			
			APPROVED BY	DATE				
A16				MATERIAL NO.	DOCUMENT NO.	SD-87760-109		
			SEE TABLE		SHEET NO. 2 OF 3		THIS DRAWING CONTAINS INFORMATION THAT IS PROPRIETARY TO MOLEX INCORPORATED AND SHOULD NOT BE USED WITHOUT WRITTEN PERMISSION	

10	9	8	7	6	5	4	3	2	1
PART NUMBER	VOID PIN LOCATIONS	CKT SIZE	A	B	M	T	PACKAGING TYPE		
87760-5116	5, 6 & 26	50	48.00	50.00	REFER TO NOTE	2.60	TUBE		
87760-531*	-	24	22.00	24.00		1.50	TRAY		
87760-5216	-	04	2.00	4.00					
87760-5416	-	20	18.00	20.00					
87760-5248	-	28	26.00	28.00		2.60	TUBE		
87760-5516	5, 6, 7, 8, 9, 10, 15, 16, 17, 18, 19, 20, 25, 26, 27, 28, 29, 30	34	32.00	34.00					

SHT 3, +87760-5516 EC NO: S2013-0842 DRAWN BY: DRW:ATSEE CHKD:SKANG APPR:MLONG 2013/05/31 2013/06/28 2013/07/08	QUALITY SYMBOLS	GENERAL TOLERANCES (UNLESS SPECIFIED)	DIMENSION STYLE	SCALE	DESIGN UNITS	THIRD ANGLE PROJECTION
	=0	mm INCH	MM ONLY	NTS	METRIC	
	=0	4 PLACES ± --- ± ---	DRAWN BY DATE	TITLE		
	=0	3 PLACES ± --- ± ---	KSEE 2003/10/15	MGRID, 2MM DUAL ROW HDR. R/A		
	=0	2 PLACES ± 0.2 ± ---	CHECKED BY DATE			
	1 PLACE ± --- ± ---	KCLING 2003/12/02				
	0 PLACE ± ±	APPROVED BY DATE	MATERIAL NO.	DOCUMENT NO.	SHEET NO.	
		SKTOH 2003/12/11	SEE TABLE	SD-87760-109	3 OF 3	
			DRAFT WHERE APPLICABLE MUST REMAIN WITHIN DIMENSIONS THIS DRAWING CONTAINS INFORMATION THAT IS PROPRIETARY TO MOLEX INCORPORATED AND SHOULD NOT BE USED WITHOUT WRITTEN PERMISSION			