



**Distributor of Sullins Connector Solutions: Excellent Integrated System Limited**

Datasheet of GTC01SBSN-M89 - CONN HEADER 1POS .100 R/A SMD

Contact us: [sales@integrated-circuit.com](mailto:sales@integrated-circuit.com) Website: [www.integrated-circuit.com](http://www.integrated-circuit.com)

---

## **Excellent Integrated System Limited**

Stocking Distributor

Click to view price, real time Inventory, Delivery & Lifecycle Information:

[Sullins Connector Solutions](#)

[GTC01SBSN-M89](#)

For any questions, you can email us directly:

[sales@integrated-circuit.com](mailto:sales@integrated-circuit.com)



Distributor of Sullins Connector Solutions: Excellent Integrated System Limited  
 Datasheet of GTC01SBSN-M89 - CONN HEADER 1POS .100 R/A SMD

PLATING SPECIFICATIONS		
CONTACT		TERMINAL
A	.000015" GOLD	.0001" TIN/LEAD
D	.00003" GOLD	.00003" GOLD OVERALL
G	.00001" GOLD	.000005" GOLD
M	.00003" GOLD	.00001" GOLD OVERALL
N	.00005" GOLD	.0001" TIN/LEAD
O	.00003" GOLD	.0001" TIN/LEAD
P	GOLD FLASH	GOLD FLASH
R	.00002" GOLD	.0001" TIN/LEAD
S	.00001" GOLD	.00001" GOLD OVERALL
T	.0001" TIN/LEAD	.0001" TIN/LEAD OVERALL
V	.00003" GOLD	.000005" GOLD
W	GOLD FLASH	.0001" TIN/LEAD
X	.00003" GOLD	.0001" TIN/LEAD
Y	.00003" GOLD	.000005" GOLD
Z	.00001" GOLD	.0001" TIN/LEAD

TERMINATION TYPES		
P/N CODE	HEAD DIMENSIONS	TAIL DIMENSIONS
BS	0.230 [5.84]	.180 [4.57]
GS	0.318 [8.08]	.180 [4.57]

PART NUMBER	BODY NUMBER	A
G_C01S_N-M89	H01R-A360	0.100 [2.54]
G_C02S_N-M89	H02R-A360	0.200 [5.08]
G_C03S_N-M89	H03R-A360	0.300 [7.62]
G_C04S_N-M89	H04R-A360	0.400 [10.16]
G_C05S_N-M89	H05R-A360	0.500 [12.70]
G_C06S_N-M89	H06R-A360	0.600 [15.24]
G_C07S_N-M89	H07R-A360	0.700 [17.78]
G_C08S_N-M89	H08R-A360	0.800 [20.32]
G_C09S_N-M89	H09R-A360	0.900 [22.86]
G_C10S_N-M89	H10R-A360	1.000 [25.40]
G_C11S_N-M89	H11R-A360	1.100 [27.94]
G_C12S_N-M89	H12R-A360	1.200 [30.48]
G_C13S_N-M89	H13R-A360	1.300 [33.02]
G_C14S_N-M89	H14R-A360	1.400 [35.56]
G_C15S_N-M89	H15R-A360	1.500 [38.10]
G_C16S_N-M89	H16R-A360	1.600 [40.64]
G_C17S_N-M89	H17R-A360	1.700 [43.18]
G_C18S_N-M89	H18R-A360	1.800 [45.72]
G_C19S_N-M89	H19R-A360	1.900 [48.26]
G_C20S_N-M89	H20R-A360	2.000 [50.80]
G_C21S_N-M89	H21R-A360	2.100 [53.34]
G_C22S_N-M89	H22R-A360	2.200 [55.88]
G_C23S_N-M89	H23R-A360	2.300 [58.42]
G_C24S_N-M89	H24R-A360	2.400 [60.96]
G_C25S_N-M89	H25R-A360	2.500 [63.50]
G_C26S_N-M89	H26R-A360	2.600 [66.04]
G_C27S_N-M89	H27R-A360	2.700 [68.58]
G_C28S_N-M89	H28R-A360	2.800 [71.12]
G_C29S_N-M89	H29R-A360	2.900 [73.66]
G_C30S_N-M89	H30R-A360	3.000 [76.20]
G_C31S_N-M89	H31R-A360	3.100 [78.74]
G_C32S_N-M89	H32R-A360	3.200 [81.28]
G_C33S_N-M89	H33R-A360	3.300 [83.82]
G_C34S_N-M89	H34R-A360	3.400 [86.36]
G_C35S_N-M89	H35R-A360	3.500 [88.90]
G_C36S_N-M89	H36R-A360	3.600 [91.44]

\*ALL CONTACT PINS HAVE A .00005" NICKEL UNDERPLATE.

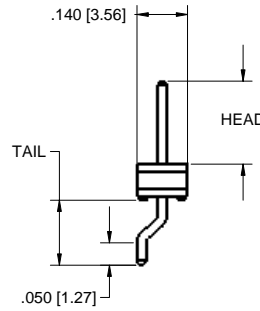
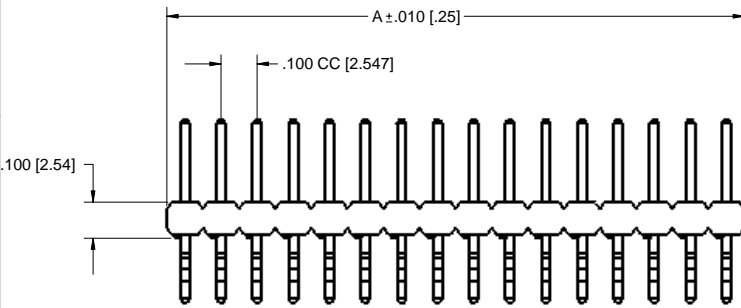

SAMPLE PART NUMBER: GTC16SBSN-M89

PLATING SPECIFICATION

TERMINATION TYPE



PROPRIETARY AND CONFIDENTIAL  
 THIS DRAWING AND DESIGN IS THE PROPERTY OF SULLINS ELECTRONICS. IT MAY NOT BE USED FOR ANY PURPOSE OTHER THAN BY THE OWNER. SULLINS ELECTRONICS DOES NOT AUTHORIZE THE REPRODUCTION OR CONVEYANCE OF ANY INFORMATION CONTAINED HEREIN.

REV.	ECO NO.	DESCRIPTION	DATE	NAME
A	62	ORIGINAL RELEASE	9/24/03	JFW
			DATE	BY
			DATE	APPV'D

UNLESS OTHERWISE SPECIFIED: DIMENSIONS ARE IN INCHES DECIMALS 1/32 ANGULAR ± 1° HOLE POSITION ± 0.010 THREE PLACE DECIMAL ± .005 FOUR PLACE DECIMAL ± .002	DRAWN: 9/24/03 CHECKED: 9/24/03 COMMENTS:	DATE: 9/24/03 NAME: JWRITE DATE: 9/24/03 NAME: AJT
--	---	---

SULLINS ELECTRONICS	
HEADERS	
G_C_ _S_ _N-M89	
SIZE: C	REV: A
DWG. NO: 10060	SCALE: 5:1
SHEET 1 OF 1	