



Distributor of Pomona Electronics: Excellent Integrated System Limited

Datasheet of 4771-12-0 - BANANA PLUG/.025 SQ RCPT 12" BLK

Contact us: sales@integrated-circuit.com Website: www.integrated-circuit.com

Excellent Integrated System Limited

Stocking Distributor

Click to view price, real time Inventory, Delivery & Lifecycle Information:

[Pomona Electronics](#)
[4771-12-0](#)

For any questions, you can email us directly:

sales@integrated-circuit.com

Pomona®

Model 4771
Square Pin Receptacle To Banana Plug

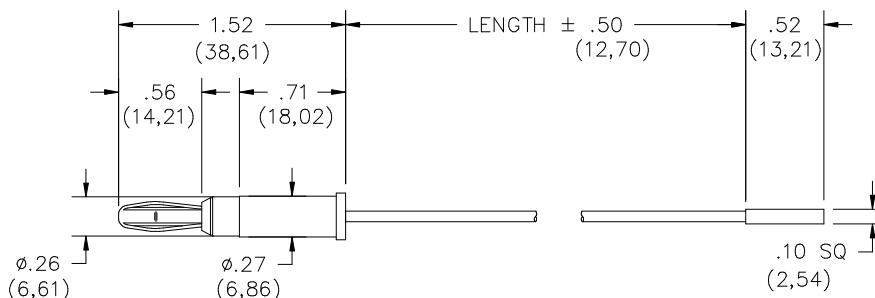

FEATURES:

- This patch cord is excellent for use as a jumper on circuit cards with 0.6 (.025) sq. pins and equipment with 4.2 (.166) dia. pin jacks.
- Mates to Model numbers 5790, 4521, and 5360.

MATERIALS:

Conn.: In-Line Banana Plug

Material: Spring – Beryllium Copper per QQ-C-533, Alloy 172, Cond. HT. Plug Body – Brass per QQ-B-626, Alloy 360, ½ Hard.

Finish: Nickel plated per QQ-N-290, Class 2, 200/300 microinches.

Insulation: Polypropylene molded to plug body and wire.

Color: Matches color of wire

Wire: 22 AWG, stranding 26 x 36 T.C., PVC Insulated, 1.63 (.064) O.D.

Color: See Ordering Information

Marking: "POMONA 4771-XX"

Conn: 0.64 (.025) Square Pin Receptacle

Material: Phosphor bronze.

Finish: Gold plated.

Housing Insulation: Polypropylene

Color: Black.

RATINGS:

Operating Temperature: +50° C (+122° F) Max

Operating Voltage: 1000 VDC

Current: 3 Amperes

ORDERING INFORMATION: Model 4771-XX-*

XX=Cable Lengths, Standard Lengths: 12" (305mm), 24" (610mm), 36" (914mm)

Additional lengths and colors can be quoted upon request.

*=Color, -0 Black, -2 Red

Ordering Example: 4771-12-2 Indicates 12" in length, color is Red.

All dimensions are in inches. Tolerances (except noted): .xx = ±.02" (.51 mm), .xxx = ± .005" (.127 mm).

All specifications are to the latest revisions. Specifications are subject to change without notice.

Registered trademarks are the property of their respective companies. Made in USA