

## Excellent Integrated System Limited

Stocking Distributor

Click to view price, real time Inventory, Delivery & Lifecycle Information:

[Pomona Electronics](#)  
[4959](#)

For any questions, you can email us directly:

[sales@integrated-circuit.com](mailto:sales@integrated-circuit.com)

# Pomona®

**Model 4959**  
**SMA, Female, PC Mount**

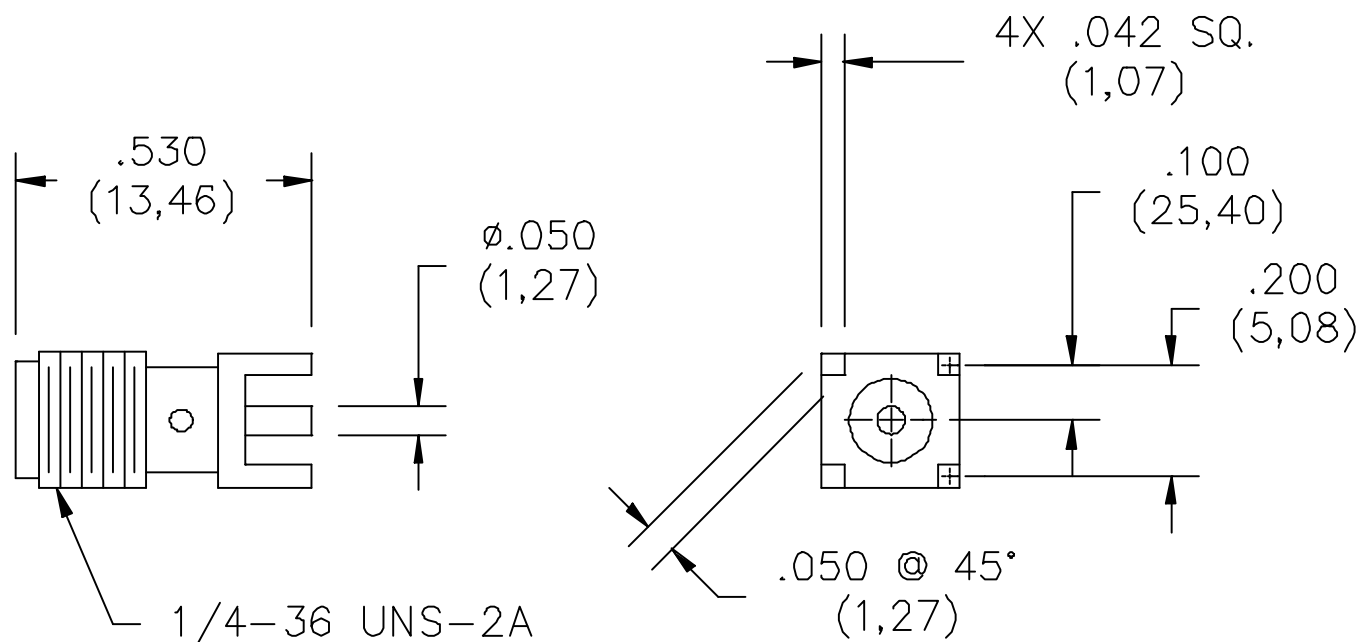

## FEATURES:

- Use to connect SMA male cables to printed circuit boards

## MATERIALS:

Body: Stainless Steel

Outer Contact: Beryllium Copper

Dielectric: PTFE

Center Contact – Gold Plated

Marking: "POMONA 4959"

## RATINGS:

Operating Temperature: -65°C. (-85°F.) to +165°C. (329°F.)

Operating Voltage: 335 VRMS Max.

Impedance: 50 Ohms

## ORDERING INFORMATION: Model 4959

All dimensions are in inches. Tolerances (except noted): .xx = ±.02" (.51 mm), .xxx = ±.005" (.127 mm).

All specifications are to the latest revisions. Specifications are subject to change without notice.

Registered trademarks are the property of their respective companies. Made in USA

**Sales: 800-490-2361 Fax: 888-403-3360**  
**Technical Assistance: 800-241-2060**

PomonaACCESS 90288 (800) 444-6785 or (425) 446-6010  
More drawings available at [www.pomonaelectronics.com](http://www.pomonaelectronics.com)