

Excellent Integrated System Limited

Stocking Distributor

Click to view price, real time Inventory, Delivery & Lifecycle Information:

[Pomona Electronics](#)
[6316-96](#)

For any questions, you can email us directly:

sales@integrated-circuit.com



Model 6316
Two WE-310 Plugs To
RJ45 / RJ48

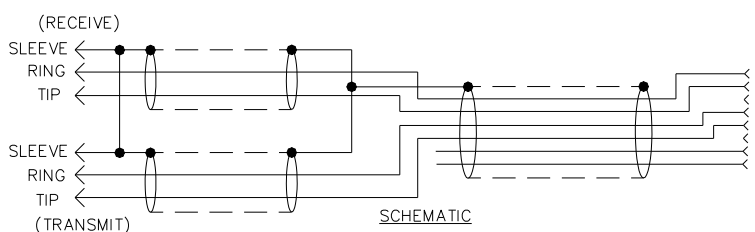
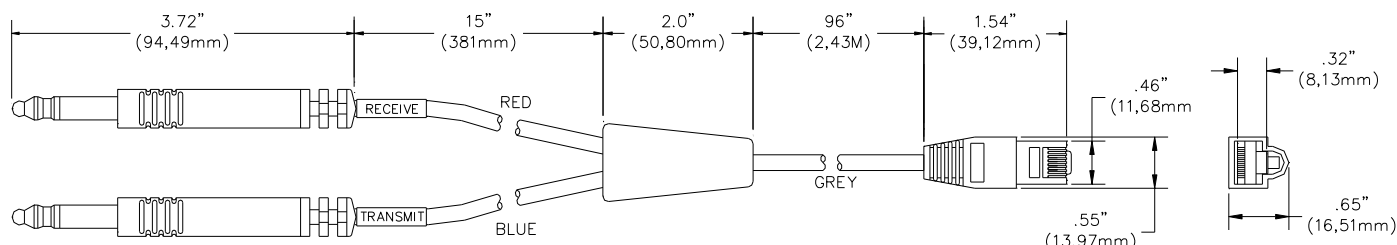

FEATURES:

- ✓ Shielded cable to reduce noise.
- ✓ WE-310 Plugs molded to the cable to provide optimum durability.

MATERIALS:

Plugs: Nickel Plated Brass.
 Main Cable: 4 Conductor Shielded Twisted Pair.
 Breakout Cables: 2 Conductor Shielded Twisted Pair.
 Wire Jackets and Insulators: PVC
 Breakout: Molded PVC

RATINGS:

Voltage: Hands free usage in controlled voltages environments: 300 Vrms Max. *For CE compliance:* not intended for hand-held use at voltage above 33 Vrms/70 Vdc.
 Current: 0.5 Amperes per conductor @ 25°C Max.
 Operating Temperature: -4°F to +176°F (-20°C to +80°C)

ORDERING INFORMATION: Model 6316-96

Standard Length: 96" Inches (2,43M)

All dimensions are in inches. Tolerances (except noted): .xx = ±.02" (.51 mm), .xxx = ±.005" (.127 mm).
 All specifications are to the latest revisions. Specifications are subject to change without notice.
 Registered trademarks are the property of their respective companies.