

## **Excellent Integrated System Limited**

Stocking Distributor

Click to view price, real time Inventory, Delivery & Lifecycle Information:

[TE Connectivity AMP Connectors](#)  
[555163-2](#)

For any questions, you can email us directly:

[sales@integrated-circuit.com](mailto:sales@integrated-circuit.com)

REV	DATE	REVISIONS	BY	CHK	APP
AA	22				
H		REV. EC 0502-0353-98			

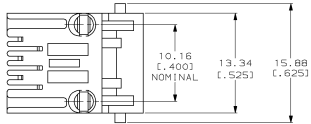
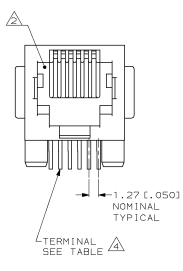
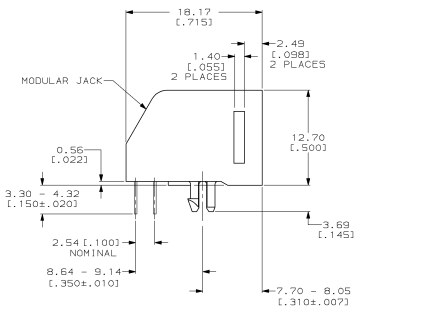

- ⚠ MATERIAL: HOUSING - PBT POLYESTER, BLACK.  
TERMINAL - 0.35 (.0138) THICK PHOSPHOROUS-BRONZE PLATED WITH 1.27µm (.000050) THICK HARD GOLD IN LOCALIZED GOLD PLATE AREA AND 2.03µm (.000080) THICK TIN LEAD IN SOLDER AREA OVER 1.27µm (.000050) THICK NICKEL UNDERPLATE.
- ⚠ CAVITY CONFORMS TO FCC RULES AND REGULATIONS PART 68, SUBPART F.
- ⚠ DIMENSIONS ARE MAXIMUM UNLESS OTHERWISE SPECIFIED.
- ⚠ TERMINALS FOR 555163-2 AND -5 LOCATED IN CENTER POSITIONS.
- ⚠ BULK PACKAGED IN A TRAY.
- ⚠ PACKAGED 36 ASSEMBLIES PER TUBE WITH BOTH ENDS CLOSED. SEE DETAIL A.

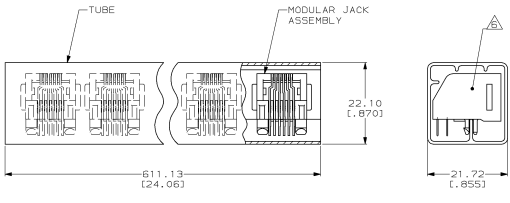

DETAIL A  
SCALE 2:1

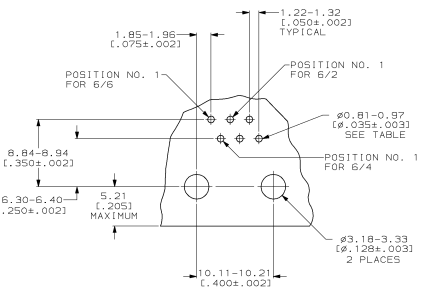

SUGGESTED PRINTED CIRCUIT BOARD MOUNTING HOLE LAYOUT  
VIEW SHOWN AS COMPONENT SIDE OF BOARD

REV	DATE	REVISIONS	BY	CHK	APP
2		555163-5			
6		555163-4			
4		555163-2			
6		555163-1			

THIS DRAWING IS A CONTROLLED DOCUMENT. DATE OF ISSUE: 25 MAR 98. DATE OF REVISION: 25 MAR 98.

AMP Incorporated  
 Harrisburg, PA 17105-3608

MODULAR JACK ASSEMBLY,  
 6 POSITION, LOW PROFILE, RIGHT ANGLE, WITH PANEL STOPS

108-1163  
 114-2048  
 A100779-0-555163

CUSTOMER DRAWING