



Distributor of Molex Connector Corporation: Excellent Integrated System Limited
Datasheet of 0480371000 - Connector Plug USB TypeA 2.0 4 Position Surface Mount, Right
Angle, Horizontal

Contact us: sales@integrated-circuit.com Website: www.integrated-circuit.com

Excellent Integrated System Limited

Stocking Distributor

Click to view price, real time Inventory, Delivery & Lifecycle Information:

[Molex Connector Corporation](#)
[0480371000](#)

For any questions, you can email us directly:
sales@integrated-circuit.com

Contact us: sales@integrated-circuit.com Website: www.integrated-circuit.com

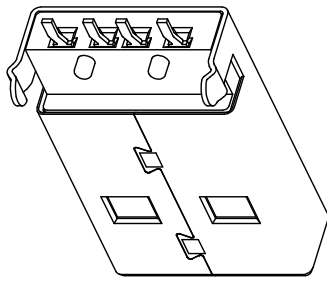
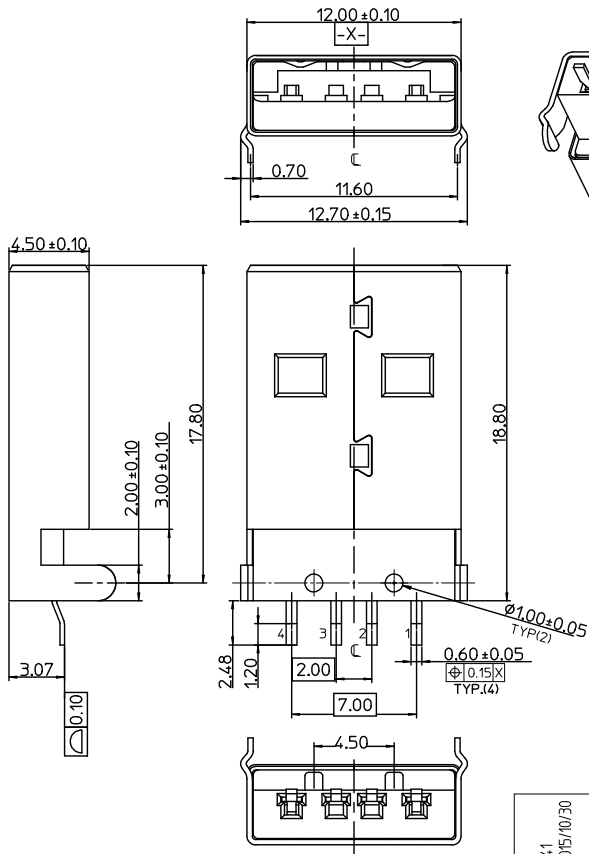

- NOTES:
- MATERIAL:
SHELL: SPCC,
HOUSING: THERMOPLASTIC GLASS FIBER FILLED.
UL94V-0, COLOR: BLACK.
CONTACT: BRASS
 - PLATING:
TERMINAL:
CONTACT AREA: GOLD(Au)
THICKNESS=30 MICROINCH MINIMUM.
SOLDER TAIL: TIN(Sn), ALLOY.
THICKNESS=120 MICROINCH MINIMUM.
UNDER PLATED: NICKEL(Ni), THICKNESS=50 MICROINCH MINIMUM.
METAL SHELL:
NICKEL(Ni), THICKNESS=120 MICROINCH MINIMUM.
UNDER PLATE: COPPER(Cu), THICKNESS=50 MICROINCH MINIMUM.
 - RECOMMENDED PCB THICKNESS: 1.20-1.60mm
 - PRODUCT SPECIFICATION: REFERS TO PS-48037-001
 - PACKAGE SPECIFICATION: SEE TABLE
 - TEST SUMMARY: REFERS TO TS-48037-001

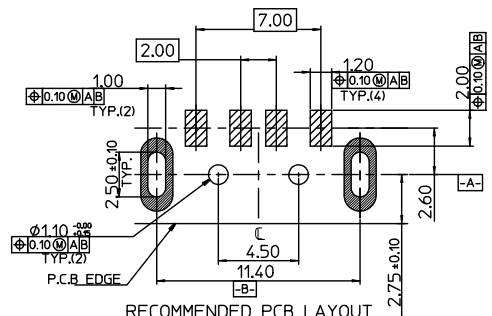

48037-2000	T&R	PK-48037-200
48037-1000	TRAY	PK-48037-001
MOLEX P/N	PACKAGE	PACKAGE SPEC

RECOMMENDED PCB LAYOUT

REVISE EC NO: SH2016-0141 DRWN: FYANG05 2015/10/30 CHKD: APPR: RZHANG 2015/11/05	QUALITY SYMBOLS $\nabla=0$ $\nabla=0$ $\nabla=0$	GENERAL TOLERANCES (UNLESS SPECIFIED)		DIMENSION STYLE		SCALE	DESIGN UNITS																																				
				MM ONLY		1:1	THIRD ANGLE PROJECTION																																				
		<table border="1"> <tr> <th></th> <th>mm</th> <th>INCH</th> </tr> <tr> <td>4 PLACES</td> <td>±---</td> <td>±---</td> </tr> <tr> <td>3 PLACES</td> <td>±---</td> <td>±---</td> </tr> <tr> <td>2 PLACES</td> <td>±0.25</td> <td>±---</td> </tr> <tr> <td>1 PLACE</td> <td>±0.25</td> <td>±---</td> </tr> </table>			mm	INCH	4 PLACES	±---	±---	3 PLACES	±---	±---	2 PLACES	±0.25	±---	1 PLACE	±0.25	±---	<table border="1"> <tr> <td>DRAWN BY</td> <td>DATE</td> <td>TITLE</td> </tr> <tr> <td>COLIN DUANG</td> <td>2003/08/22</td> <td>USB A TYPE PLUG R/A CONNECTOR(SMT)</td> </tr> <tr> <td>CHECKED BY</td> <td>DATE</td> <td></td> </tr> <tr> <td>APPROVED BY</td> <td>DATE</td> <td></td> </tr> <tr> <td>WILSON CHANG</td> <td>2003/08/22</td> <td></td> </tr> </table>		DRAWN BY	DATE	TITLE	COLIN DUANG	2003/08/22	USB A TYPE PLUG R/A CONNECTOR(SMT)	CHECKED BY	DATE		APPROVED BY	DATE		WILSON CHANG	2003/08/22		<table border="1"> <tr> <td>MATERIAL NO.</td> <td>DOCUMENT NO.</td> <td>SHEET NO.</td> </tr> <tr> <td>SEE TABLE</td> <td>SD-48037-002</td> <td>1 OF 1</td> </tr> </table>		MATERIAL NO.	DOCUMENT NO.	SHEET NO.	SEE TABLE	SD-48037-002	1 OF 1
			mm	INCH																																							
4 PLACES	±---	±---																																									
3 PLACES	±---	±---																																									
2 PLACES	±0.25	±---																																									
1 PLACE	±0.25	±---																																									
DRAWN BY	DATE	TITLE																																									
COLIN DUANG	2003/08/22	USB A TYPE PLUG R/A CONNECTOR(SMT)																																									
CHECKED BY	DATE																																										
APPROVED BY	DATE																																										
WILSON CHANG	2003/08/22																																										
MATERIAL NO.	DOCUMENT NO.	SHEET NO.																																									
SEE TABLE	SD-48037-002	1 OF 1																																									
DRAFT WHERE APPLICABLE MUST REMAIN WITHIN DIMENSIONS		SIZE A3		THIS DRAWING CONTAINS INFORMATION THAT IS PROPRIETARY TO MOLEX INCORPORATED AND SHOULD NOT BE USED WITHOUT WRITTEN PERMISSION																																							