

Excellent Integrated System Limited

Stocking Distributor

Click to view price, real time Inventory, Delivery & Lifecycle Information:

[Molex Connector Corporation](#)
[25001-0606](#)

For any questions, you can email us directly:

sales@integrated-circuit.com

CABLE SPECIFICATIONS:

1.- STANDARD JUMPER SERIES # 25001 (8996 CABLE .125" S/R BOTH ENDS)

2.- PHYSICAL

CONDUCTOR SPACING100" (2.54mm) ϕ TO ϕ
 WIRE GAUGE 26 AWG (17/34), STRANDED, TOPCOAT
 INSULATION GRAY PVC
 EDGE MARK COLOR RED

3.- AGENCY

U.L. STYLE 2651
 TEMPERATURE RATING -20 °C TO 105 °C
 VOLTAGE RATING 300V. MAX.
 FLAMMABILITY RATING VW-1

4.- SPECIAL REQUIREMENT

RHS AND LEAD FREE COMPLIANT
 NO TEXT MARKING ON FCB

5.- GENERAL

NON-OPERATING TEMPERATURE... -20°C TO 105°C Δ

6.- SOLDERING CONDITION

SOLDER TEMPERATURE.....260°C. MAX.
 SOLDERING TIME.....3 SECOND. MAX.
 INSULATION SHRINK.....2MM. NOM

PREFER STRIP & RETAIN

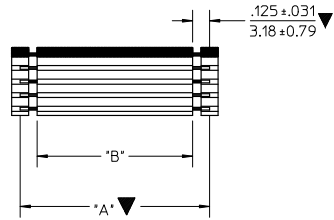

PCB HOLE LAYOUT
 RECOMMENDED HOLE DIA. .032 In.

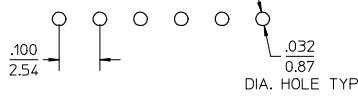

OVERALL LENGTH ("A")
 TOLERANCE FOR OAL +/- .100"
 INSULATION LENGTH ("B" REF.)
 DIMS "A" & "B" REFERS TO
 SHOWN IN MATRIX.

MATRIX FOR STANDARD JUMPERS SERIES # 25001 (8996 CABLE .125" S/R BOTH ENDS)									
LENGTH "A" (±.100")	1.250"	2.250"	3.250"	4.250"	5.250"	6.250"	7.250"	8.250"	
LENGTH "B" CIRCUITS (REF)	1.000"	2.000"	3.000"	4.000"	5.000"	6.000"	7.000"	8.000"	
3	25001-0301	25001-0302	25001-0303	25001-0304	25001-0305	25001-0306	25001-0307	25001-0308	
4	25001-0401	25001-0402	25001-0403	25001-0404	25001-0405	25001-0406	25001-0407	25001-0408	
5	25001-0501	25001-0502	25001-0503	25001-0504	25001-0505	25001-0506	25001-0507	25001-0508	
6	25001-0601	25001-0602	25001-0603	25001-0604	25001-0605	25001-0606	25001-0607	25001-0608	
7	25001-0701	25001-0702	25001-0703	25001-0704	25001-0705	25001-0706	25001-0707	25001-0708	
8	25001-0801	25001-0802	25001-0803	25001-0804	25001-0805	25001-0806	25001-0807	25001-0808	
9	25001-0901	25001-0902	25001-0903	25001-0904	25001-0905	25001-0906	25001-0907	25001-0908	
10	25001-1001	25001-1002	25001-1003	25001-1004	25001-1005	25001-1006	25001-1007	25001-1008	
11	25001-1101	25001-1102	---	---	---	---	---	---	

25001-***
 A B C

A = STD. JUMPER I.D. No
 B = CIRCUIT SIZE
 3 THRU 11
 C = DENOTES LENGTH
 1.000" TO 8.000"

SEE CHANGE DETAIL EC NO: THL2008-0019 DRW: CPANS AKHOM 2007/12/07 CHK: DANCHALENY 2007/12/11 APPR: SV IRAT JAPOL 2007/12/20	QUALITY SYMBOLS ▽=3 ▽=0	GENERAL TOLERANCES (UNLESS SPECIFIED)		DIMENSION STYLE IN/MM		SCALE NTS	DESIGN UNITS INCH	THIRD ANGLE PROJECTION	
		4 PLACES ± --- ± ---	3 PLACES ± --- ± ---	2 PLACES ± --- ± ---	1 PLACE ± --- ± ---	ANGULAR ± --- °	DRAWN BY DATE PMEECHAI 2006/05/17		STANDARD JUMPER .100" CTR PVC INSULATED 26 AWG STR. TOPCATED MOLEX INCORPORATED
		DRAFT WHERE APPLICABLE MUST REMAIN WITHIN DIMENSIONS					CHECKED BY DATE DNARINTARA 2006/05/17		
		APPROVED BY DATE SV IRAT JAPOL 2006/05/17					MATERIAL NO. SEE CHART		
					SIZE A4	THIS DRAWING CONTAINS INFORMATION THAT IS PROPRIETARY TO MOLEX INCORPORATED AND SHOULD NOT BE USED WITHOUT WRITTEN PERMISSION		SHEET NO. 1 OF 1	

tb_frame_A4_P_ME_T
 Rev. E 2006/04/15

6

5

4

3

2

1