

## Excellent Integrated System Limited

Stocking Distributor

Click to view price, real time Inventory, Delivery & Lifecycle Information:

[Molex Connector Corporation](#)  
[25001-0706](#)

For any questions, you can email us directly:

[sales@integrated-circuit.com](mailto:sales@integrated-circuit.com)

**CABLE SPECIFICATIONS:**

**1.- STANDARD JUMPER SERIES # 25001 (8996 CABLE .125" S/R BOTH ENDS)**

**2.- PHYSICAL**

CONDUCTOR SPACING ..... .100" (2.54mm)  $\phi$  TO  $\phi$   
 WIRE GAUGE ..... 26 AWG (17/34), STRANDED, TOPCOAT  
 INSULATION ..... GRAY PVC  
 EDGE MARK COLOR ..... RED

**3.- AGENCY**

U.L. STYLE ..... 2651  
 TEMPERATURE RATING ..... -20 °C TO 105 °C  
 VOLTAGE RATING ..... 300V. MAX.  
 FLAMMABILITY RATING ..... VW-1

**4.- SPECIAL REQUIREMENT**

RHS AND LEAD FREE COMPLIANT  
 NO TEXT MARKING ON FCB

**5.- GENERAL**

NON-OPERATING TEMPERATURE... -20°C TO 105°C  $\Delta$

**6.- SOLDERING CONDITION**

SOLDER TEMPERATURE.....260°C. MAX.  
 SOLDERING TIME.....3 SECOND. MAX.  
 INSULATION SHRINK.....2MM. NOM

PREFER STRIP & RETAIN

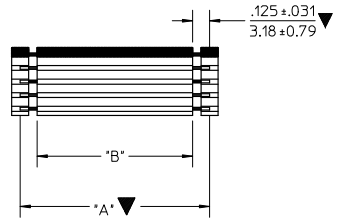

**PCB HOLE LAYOUT**  
 RECOMMENDED HOLE DIA. .032 In.

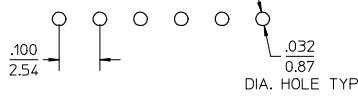

OVERALL LENGTH ("A")  
 TOLERANCE FOR OAL +/- .100"  
 INSULATION LENGTH ("B" REF.)  
 DIMS "A" & "B" REFERS TO  
 SHOWN IN MATRIX.

MATRIX FOR STANDARD JUMPERS SERIES # 25001 (8996 CABLE .125" S/R BOTH ENDS)									
LENGTH "A" (±.100")	1.250"	2.250"	3.250"	4.250"	5.250"	6.250"	7.250"	8.250"	
LENGTH "B" CIRCUITS (REF)	1.000"	2.000"	3.000"	4.000"	5.000"	6.000"	7.000"	8.000"	
3	25001-0301	25001-0302	25001-0303	25001-0304	25001-0305	25001-0306	25001-0307	25001-0308	
4	25001-0401	25001-0402	25001-0403	25001-0404	25001-0405	25001-0406	25001-0407	25001-0408	
5	25001-0501	25001-0502	25001-0503	25001-0504	25001-0505	25001-0506	25001-0507	25001-0508	
6	25001-0601	25001-0602	25001-0603	25001-0604	25001-0605	25001-0606	25001-0607	25001-0608	
7	25001-0701	25001-0702	25001-0703	25001-0704	25001-0705	25001-0706	25001-0707	25001-0708	
8	25001-0801	25001-0802	25001-0803	25001-0804	25001-0805	25001-0806	25001-0807	25001-0808	
9	25001-0901	25001-0902	25001-0903	25001-0904	25001-0905	25001-0906	25001-0907	25001-0908	
10	25001-1001	25001-1002	25001-1003	25001-1004	25001-1005	25001-1006	25001-1007	25001-1008	
11	25001-1101	25001-1102	---	---	---	---	---	---	

25001-\*\*\*  
 A B C

A = STD. JUMPER I.D. No  
 B = CIRCUIT SIZE  
 3 THRU 11  
 C = DENOTES LENGTH  
 1.000" TO 8.000"

SEE CHANGE DETAIL EC NO: THL2008-0019 DRW:CPANS AKHOM 2007/12/07 CHK:DNCHALENY 2007/12/11 APPR:SV IRAT JAPOL 2007/12/20	QUALITY SYMBOLS ▽=3 ▽=0	GENERAL TOLERANCES (UNLESS SPECIFIED)		DIMENSION STYLE IN/MM		SCALE NTS	DESIGN UNITS INCH	THIRD ANGLE PROJECTION
		4 PLACES ± --- ± ---	DRAWN BY DATE PMEECHAI 2006/05/17	STANDARD JUMPER .100" CTR PVC INSULATED 26 AWG STR. TOPCATED				
		3 PLACES ± --- ± ---	CHECKED BY DATE DNARINTARA 2006/05/17					
		2 PLACES ± --- ± ---	APPROVED BY DATE SV IRAT JAPOL 2006/05/17	MATERIAL NO. SEE CHART		DOCUMENT NO. SD-25001-001	SHEET NO. 1 OF 1	
DRAFT WHERE APPLICABLE MUST REMAIN WITHIN DIMENSIONS		THIS DRAWING CONTAINS INFORMATION THAT IS PROPRIETARY TO MOLEX INCORPORATED AND SHOULD NOT BE USED WITHOUT WRITTEN PERMISSION						

tb\_frame\_A4\_P\_ME\_T  
 Rev. E 2006/04/15

6

5

4

3

2

1